



Livelähetys
osoitteessa
www.moottoriurheilu.tv

SM ITÄRALLI 29.2



RALLY GUIDE

Live stream: www.moottoriurheilu.tv

Vauhdissa mukana:



Content

RALLY GUIDE

PROGRAMM AND IMPORTANT DATES

CONTACT

ADVERTISEMENTS

RALLY TICKETS

RESTAURANT

RALLY AND SERVICE CARS PARTKING

DOCUMENT CHECKS

TIMEKEEPING TRANSPONDER AND SAFETY EQUIPMENT PICK AND RETURN

PLEASE PAY ATTENTION DURING RECCE

SAFETY SCRUTINEERING

DURING RALLY

SERVICE PARK

REFUELLING

DISTANCES

RESULTS

PRIZE GIVING CEREMONY

ATTACHMENTS

NOTE: This document is translation of Finnish Rally info. In cases of any doubt, original Finnish text is valid.

PROGRAMM AND IMPORTANT DATES

27.2.2020 18:00	Rally Headquarter (HQ) opens, Jukolankatu 18, Joensuu, voluntary document checks and sharing of recce material, only for classes 1-6 ja 13-16
28.2.2020	NOTE: SS 6 is cancelled
07:00	Rally Headquarter (HQ) opens, Jukolankatu 18, Joensuu
07:10	Document checks and sharing of recce material, only for classes 1-6 ja 13-16
07:30	Reconnaissance starts SS 1-5, classes1-6 and 13-16
15:00	Document checks ends classes1-6 and 13-16
15:30	Safety Scrutineering checks starts, classes 1-6. REMEMBER TO RESERVE TIME FROM slotti.fi see chapter 16.
18:00	Reconnaissance ends SS 1-5, classes1-6 and 13-16
20:00	HQ closed
20:00	Safety Scrutineering checks ends, classes 1-6
29.2.2020	NOTE: SS 6 is cancelled
7:30	Rally Headquarter (HQ) opens, Jukolankatu 18, Joensuu
8:00	Document checks and sharing of material, for classes 7-12 and 17-19 ja 13-16
8:00	Safety Scrutineering checks starts, classes 7-19
8:00	Entry list publish, update every 30 minutes
10:00	Document check ends classes7-19
10:01	Rally Start, Joensuu Market Place, city center, Torikatu, 80100 Joensuu
10:30	Safety Scrutineering checks ends, classes 7-19
12.25	Service 1, Car number 1
14.26	Service 2, Car number 1
18.35	Rally Finish, AT 5CTrotting Track Joensuu, Prize giving ceremony, Joensuu Market Place
18:45	Rally results

CONTACT

RALLY HQ

Jukolankatu 18, Joensuu. Secretary Henna Pallonen, p. +358 40 582 9822,

henna.pallonen@saunalahti.fi or Jaana Mäkisalo 0400 299 208, jaana@joeu.fi

Competitors Relations Officer Timo Turunen +358 400 473 799, timo.joeu@gmail.com

HQ OPEN:

Thursday 27.2.2020 18.00- 20.00

Friday 28.2.2020 7.00- 20.00

Saturday 29.2.2020 7.30- 1 hour after last competitor finish app. 21:30

OFFICIAL NOTICE BOARD

In Rally HQ and web site www.itaralli.fi

MEDIA CENTER

Rally HQ Jukolankatu 18, Joensuu.

Media Officer Timo Louhelainen, +358 40 8328 356, timolouhelainen@hotmail.com.

Media ASN Suvi Nisula, +358 40 842 6155, suvi.nisula@autourheilu.fi

MEDIA CENTER OPEN

Friday 28.2.2020 17.00 - 20.00

Saturday 29.2.2020 8.00 – 1 hour after last competitor finish app. 21:30

COMPETITORS RELATIONS OFFICERS



Timo Turunen (ENG)
+358 400 473 799
timo.joeua@gmail.com



Aulis Ahonen
+358 50 535 5100

Available during whole event

IMPORTANT PHONE NUMEBRS

Taxi 0601 10100

Towing ApuPesoset 0400 374 802

Hotel Kimmel 020 1234 663

ADVERTISEMENTS

Adverts in car numbers:



RALLY TICKETS

SS TICKET 10€/ person/ SS (only for sale in SS)

Kids under 12yrs free with adults

RALLY PASS 25€, 1 rally pass, access to every SS, rally info, SS info, map.

VIP-PASS 100€ / access to every SS, rally info, SS info, map, dinner in VIP lounge

RALLY PASSES ARE SOLD:

Gulf, Honkavaara

Lähi-ABC Kontiolahti, Uuro

Lähi-ABC Siihtala, Joensuu

JPM Myynti, Uimaharju

Neste Sortavalankatu, Joensuu

Neste Tolosenmäki, Kitee

SEO Heinävaara

ST1 Kontiolahti

R-kioski, Eno

Teboil Kirkkokatu, Joensuu

Teboil Kovero

Kilpailukeskus

RESTAURANT

Restaurant is in Rally HQ, lunch buffee on Friday and Saturday, 10€. Also coffee etc.

Saturday 11.30 - 16.30.

RALLY AND SERVICE CARS PARKING OVER NIGHT

Rally car overnight parking, please ask Matti Röning, +358 50 3304984

PARKING

Service park in Rally HQ, Jukolankatu 18, Joensuu, only 1 service car/ competitor

TRAILER PARK

Trailer park and unloading, Helatie 24 ja 26, Joensuu.

SERVICE PARK AND TRAILER PARK

Opens 28.2.2020. at 15.00. NOT before that

Trailer park gate is closed during nighttime 28.02. 20.00 – 29.2. 7.00

No trailers in Service Park

DOCUMENT CHECKS

Classes 1-6 and 13-16 Jukolankatu 18, Joensuu,

Thursday 27.2.2020. klo 18.00-20.00.

Friday 28.2. starting from 7:10

Classes 7-12 and 17-19, Saturday 29.2. starting from 8:00

DOCUMENTS TO BE CHECKED

- Driver's driving license
- Co- drivers ID
- Entrant's license (if not same than driver or co-driver)

Organizer wants to have from you:

- signature to entry form and given materials
- contact info of recce and service
- Information document for announcer

If any changes to entry information, please inform organizer asap

COMPETITOR WILL GET FROM ORGANICER:

- Road book 1
- Map 2
- Numbers to recce car 2pcs, classes 1-6 and 13-16
- Service car pass 1
- Service park map 1
- Numbers to rally car: 2 for doors, 2 for back side windows

material not needed for recce, can be left to HQ, for later pick-up by team member

TIMEKEEPING TRANSPONDER AND SAFETY EQUIPMENT PICK AND RETURN

Safety equipment is used in every class. Classes 1-12 will get the new models (smartphones) which will need continuous power. USB 12V or min 5V 2A. Classes 13-16 will use previous models, which have their own battery (with SOS button)

Instructions for use attached. Info in Finnish, for details please ask in Rally HQ or **Mr. Mikko Huuska +358 40 547 8775**

AKK Sports Oy
Mikko Huuska

etunimi.sukunimi@autourheilu.fi puh. +358 40 5478775

SAFETY EQUIPMENT FOR RECCE

At Rally HQ
Thursday 27.2. 18:00 – 20:00 during document checks

Friday 28.2. from 07:10

Classes 1-6 will return equipment after rally in TC 5C

Classes 13-16 will return equipment after recce and will pick it up again before start on Saturday starting from 7:10

TIMEKEEPING TRANSPONDER AND SAFETY EQUIPMENT PICK FOR RALLY ON SATURDAY 29.2.2020

- classes 1-6 will pick-up TIME KEEPING TRANSPONDER from Rally HQ, starting from 8:00
- classes 7-12 will pick-up safety equipment and time keeping transponder during document check in HQ
- classes 13-16 will pick-up safety equipment and time keeping transponder starting from 8:00
- classes 17-19 pick-up safety equipment and time keeping transponder during document check in HQ

SAFETY EQUIPMENT needs to be fixed according instruction attached

TIME KEEPING TRANSPONDER needs to be fixed with sticker inside, beside windscreen mirror. NOT to roll gage

Competitor is responsible for installation of equipment

RETURN:

Both equipment will be returned to rally finish, TC 5C.

In case of retirement, equipment needs to be returned asap, latest to **PURKU 2** -car, which drives all stages through after last competitor. Lost or broken equipment will be charged 150€.

PLEASE PAY ATTENTION DURING RECCE

Reconnaissance starts on Friday 28.02. at 7.30 and ends at 18:00

During recce it is allowed to drive through the stages two (2) times

All signs in road book are in place also during recce, but please notice, marks are temporary!

Organizer is controlling that all stages are driven through max twice and also speed with GPS

SPECIAL STAGES DRIVEN EARLIER

SS 2 same than SM Itäralli 2019 SS 2

SS 3 same than SM Itäralli 2019 SS 3

SS 4 same than SM Itäralli 2019 SS 4

SS 5 same than SM Itäralli 2019 SS 5

SAFETY SCRUTINEERING

Rally car numbers needs to be fixed when arriving to Safety Check. Car needs to have also normal tyres, rally tyres not allowed.

Competitor needs to reserve time for scrutineering form "Slotti" system.

<https://slotti.fi/booking/rallism/> from 21.02.2020 12:00 – to 26.02.2020 klo 22:00.

Classes 1-6 scrutineering on Friday from 15:00 to 21:00

Classes 7-19 Saturday 29.2. from 8:30 to 11:30

During Safety check main object is to check all safety equipment of car and drivers, including HANS / FHRs

IN SAFETY CHECK COMPETITOR/ TEAM NEEDS TO PRESENT:

- Scrutineering document given by AKK (Finnish ASN) (not required from international competitors)
- Car homologation document
- Roll gage homologation document or certificate (if applicable)
- Registration document or Finnish traffic insurance document

NOTE: you need to Finnish traffic insurance (and sticker plates) for rally car. Closest place to get the insurance and plates is Joen Katsastus, Aspitie 9, 80100 JOENSUU, located approx. 1km from Rally HQ. If any questions, please contact Timo Turunen +358 400 473 799

For fluent Safety Check we kindly ask competitor (or his authorized person) to present rally cars documentation latest 10minutes before own reserved time. There is no separate TC in Safety Check, document check desk is the TC

Scrutineering document will be given to competitor in here. After approved Safety Check, document will stay at organizer.

SEALING

Competitor or his representative needs to prepare all equipment ready to be sealed. Sealing wires needs to be in place. After adding the seals, parts will be added to scrutineer document.

DRIVERS EQUIPMENT

Drivers equipment are also checked during Safety Check.

MARKING OF TYRES (classes 1-5 and 7-12)

In Classes 1-5 it is allowed to use max 8 tires.

Competitor needs to give list of FIA codes from all tires which are used in event. List of tyre codes is as attachment in this document. Filled document needs to given to organizer latest at Safety Check, when showing cars documentation. Tyre form attached below

If you do not have FIA coded tires, please contact Chief Scrutineer Mr. Timo Brilli (+358 400 420 458) He will give additional information for marking.

Technical checking (if needed) after event will be arranged in Jukolankatu18, 80100 JOENSUU.

DURING RALLY

DRESSING ROOMS

During whole event at Rally HQ

START

Start

- Rally Start is in Joensuu Market Place, city center, starting at 10.00, with interval of 1 minute There is no separate Parc Fermé in start area, please arrive app. 10 minutes before your own starting time.

Space in starting area is limited, please do not come too early. List of competitors allowed to start is published in Official Notice Board in Rally HQ, starting at 29.2 from 8.00 and updated after every 30 minutes. Timecard will be given to competitor in start TC.

TIME CARDS

There will be two (2) timecards in rally

SHARE

Timecard 1 TC Start

Timecard 2 TC 2D

RETURN

SERVICE TC 2D

TC Finish

Retirement

In case of retirement, competitor needs to inform it by cell phone to number which is in road book or retirement needs to be informed to nearest TC (AT)

SERVICE PARK AND SERVICE

1. service after SS2 and 2nd service after SS3.

There is TC both service in and out. So called Flexi service.

Centralized Service Park. Other areas only drivers can do maintenance with tools which are in rally car during event.

FINISH

Rally finish is TC 5C.

After TC 5C, drivers deserved for prize giving ceremony are collected to re-grouping area and guided to Market place. (same area as rally start)

SERVICE PARK

Service Park is opens on Friday at 15:00. Entry before that forbidden. No trailers allowed.

Organizer will reserve space for every competitor according Finnish Rally Championship regulations Note: no guarding during night.

Only one service car to Service Park for each competitor. Please put service car sign ("Huoltoauto") with register plate number, to windscreen. That sign needs to be visible during whole event. Smoking is allowed only in marked places, see the map. Organizer is controlling area during event.

FLEXI SERVICE

In SS 2 finish TC 2B competitor will get time for "service-out" to time card. This time includes road section from SS finish to service park, technical check time, break and service time. Service park in TC is "early entry" allowed. There will be given "Service start time" to competitor (separate document). This needs to be visually seen by organization and service can be started only that time.

After "Service-in TC", there is technical check are (min 3 minutes)

SERVICE FOR CLASSES 1-12

Service and break (re-grouping)

Service can be started at given time

1. Service 20 minutes + technical check time 3 min after SS2
2. Service 30 minutes and break (re-grouping) 30 – 3min after SS 3

SERVICE FOR CLASSES 13-19

Service can be started after arrival to service park

1. Service 20 – 15 min after SS2
2. Service 30 – 20 min, break (re-grouping) 30 – 0 min, after SS3

REFUELLING

Refueling is marked on road book and fueling is allowed only in those places. FIA fuel refuelling is allowed in specified area in Service park. E85 refueling is allowed in specified area in Service park and gas station SEO Heinävaara.

DISTANCES

E85:

	Road			
Between	Section	SS	Refuelling	Place
Start - Refuelling 1	81,6	26,0	1	Service park
Refuelling 1 - Refuelling 2	51,3	33,2	2	Service park
Refuelling 2 - Refuelling 3	26,4	0,0	3	SEO HEINÄVAARA
Refuelling 3 - Refuelling 4	46,3	39,0	4	SEO HEINÄVAARA
Refuelling 4 - Finish	29,5			

FIA fuel:

	Road			
Between	section	SS	Refuelling	Place
Start- Refuelling 1	81,6	26,0	1	Service park
Refuelling 1 - Refuelling 2	51,3	33,2	2	Service park
Refuelling 2 – Finish	102,7	39,0		

Gas Station:

Between	Road section	SS	Refuelling	Place
	36,5			Start
		14,45		SS1
Refuelling 1	14,0		1	GULF, Honkavaara
	5,3			
		11,5		EK2
TANKKAUS MAHDOLLISUUS 2	14,3		2	ST1 Reijola
	11,6			Service 1 1
Refuelling 3	15,6		3	ST1, Kontiolahti
	4,5			
		33,2		SS3
Refuelling 3	17,5		4	NESTE / ABC, UURO
	13,6			Service 2
Refuelling	46,8		5	TEBOIL KOVERO
	9,8			
		26,60		SS4
	6,30			
		12,4		SS5
Refuelling 5	10,1		6	SEO HENÄVAARA
	29,2			MAALI

RESULTS

Unofficial results will be published 17:45 in official notice board and final results in KITI web site <https://akk.autourheilu.fi/Public/Kiti/Competition/CompetitionOpen.aspx?id=9241&edit=0> and www.itaralli.fi and www.rallism.fi

PRIZE GIVING CEREMONY

For all class ceremony at Joensuu market place according un- official results

Trophies

Class	Throphies	Class	Throphies
SM1	1 - 3	RJSM 11	1 - 3
SM2	1 - 3	14	1
SM3	1 - 3	15	1
SM4	1 - 3	16	1 - 3
SC5	1 - 3	17	1
SC6	1	18	1 - 5
RJSM7	1 - 3	19	1
RJSM8	1 - 3		
RJSM9	1 - 3		
RJSM10	1 - 3		

ATTACHMENTS

All attachments are also published in www.itaralli.fi

RECONNAISSANCE INFO

Announcer info

Changes to entry

Tyres bar code form

Permission for lights, tyres and windscreen advertisement 2020-2023

Joensuu City map

Service Park arrangements

Rally start and Finish arrangements in Market Place

Safety equipment instructions (smartphone)

Safety equipment instructions (old school version)

ENNAKKOTUTUSTUMISTIETOLOMAKE

RECONNAISSANCE INFO

Kilpailijnumero / Competitor Number
1-ohjaaja/driver
Matkapuhelin/mobile phone no.
2-ohjaaja/co-driver
Matkapuhelin/mobile phone no.
Tutustumisauton merkki ja malli/mark and model of the reconnaissance car
Rekisterinumero/registration number Väri/colour

HUOLTOAUTON YHTEYSTIEDOT CONTACT INFORMATION OF THE SERVICE STAFF

Yhteyshenkilö/contact person
Matkapuhelin/mobile phone no.
KILPAILUAIKAINEN PUHELINNUMERO TEKSTIViestijärjestelmää VARTEN
MOBILE PHONE NO DURING EVENT FOR THE TEXTMESSAGES SYSTEM
Matkapuhelin kuljettajille/Mobile phone no. to drivers
Matkapuhelin huoltoon/Mobile phone no. to service

PALAUTA TÄMÄ LOMAKE ASIAPAPERITARKISTUKSEN YHTEYDESSÄ!

PLEASE RETURN THIS FORM TO THE RALLY OFFICE WHEN CHECKING IN THE RALLY!

SM-ITÄRALLI 29.2.2020 Joensuu

INFO TO ANNOUNCER

Number: _____

Driver: _____

Nat _____

Profession _____

age: _____

Co- driver: _____

Nat _____

Profession _____

age: _____

Car: _____

Expectations for Itäralli _____

Sponsors: _____

Plans for season 2020: _____

Previous achievements: _____

SM Itäralli 29.2.2020

MUUTOKSIA ILMOITTAUTUMISEEN
CHANGES TO ENTRY FORM

Number

OHJAAJAN VAIHTO
CHANGING
☐ 1-ohjaaja / driver ☐ 2-ohjaaja / co-driver

ILMOITETTU OHJAAJA COMPETITOR ENROLMENT	Nimi / name	Licence number
UUSI OHJAAJA NEW COMPETITOR	Nimi / name	Licence number
	email	Mobile phone

ILMOITTAJAN VAIHTO
CHANGING ENTRANT

UUSI ILMOITTAJA NEW ENTRANT	NIMI / name	Licence number
	email	Mobile phone

AUTON VAIHTO
CHANGING RACE CAR

New car	Model of car	Scrutineering card no:
group	Homologation no:	Engine capacity
Traffic insurance company	Year of manufacturing	Registration number

Päiväys/ Date ____/____ 2020

Allekirjoitus/ Signature



Kilpailu-
numero
Competition
number

RENGASKOODILOMAKE – TYRE BAR CODE FORM

Tällä lomakkeella ilmoitetaan kilpailijan rallissa käyttämien renkaiden FIA-viivakoodien numerot Sarjasääntöjen art. 16.2.1 ja kilpailun sääntöjen sekä lisämääräysten mukaisesti.

This form is used to inform the organiser of the FIA bar code numbers of all tyres to be used in a rally by the competitor, as stipulated in Art. 16.2.1 of the FRC regulations, and in the supplementary regulations or bulletins of the event.

Kilpailun nimi/Event: SM ITÄRALLI 29.2.2020

1-ohjaaja/Driver: _____

Merkki/Make	Tyyppi/Type	FIA-viivakoodinro/FIA Bar Code No.

TRAFICOM

Liikenne- ja viestintävirasto
Transport- och kommunikationsverket

PÄÄTÖS SM ITÄRALLI 29.2.2020

AKK-Motorsport Ry

Iiro Palmi
PL 19
01310 Vantaa

Päiväys/Datum

08.01.2020

Dnro/Dnr

TRAFICOM/9195/05.03.44/2020

Viite/Referens

Poikkeuksen myöntäminen ajoneuvon rakennetta ja varusteita sekä käyttöä tiellä koskevista vaatimuksista**Asia**

AKK-Motorsports Ry on hakenut Liikenne- ja viestintävirasto Traficomilta poikkeusta rallikilpailuissa käytettävien autojen vaatimusten osalta.

Hakijan kilpailukalenteriin merkityissä rallikilpailuissa käytettävien autojen renkaat eivät täytä vaatimuksia seuraavilta osin:

1. Nastojen ulkonema ylittää ajoneuvojen käytöstä tiellä annetun asetuksen 17 § 5 momentissa ja asetuksen ajoneuvon renkaiden nastoista 2 § 3 momentissa säädettyt mitat;
2. Nastojen lukumäärä ja pistovoima ylittävät asetuksen ajoneuvon renkaiden nastoista 2 § 1 momentissa ja 3 § 2 momentissa määrätyt arvot;
3. Renkaissa käytetyt nastat eivät ole tyyppihyväksyttyjä asetuksen ajoneuvon renkaiden nastoista 3 §:n mukaisesti.



Rallikilpailuissa käytettävien autojen valaisimet poikkeavat määrän, valotehon ja hyväksynnän osalta autojen ja niiden perävaunujen teknisistä vaatimuksista annetun määräyksen liitteen 1 taulukon kohdan 20 vaatimuksista. Autot eivät myöskään kaikilta osin täytä määräyksen liitteen 1 taulukon kohdan 32 etunäkyvyysaluetta koskevia vaatimuksia tuulilasiin kiinnitettyjen tarrojen vuoksi.

Ajoneuvot

AKK-Motorsport Ry:n kilpailukalenteriin merkityissä, tiellä ajettavissa rallikilpailuissa käytettävät autot.

Päätös

Traficom hyväksyy hakemuksen.

Päätös on voimassa 31.12.2023 asti seuraavin erityisehdoin käytettäessä tässä päätöksessä tarkoitettua ajoneuvoa kilpailussa sekä matkalla kilpailuun ja sieltä pois tai kilpailun edellyttämässä katsastuksessa käyntiin.

1. Tämän päätöksen tarkoittamia nastarenkaita saadaan käyttää vain hakijan järjestämissä kilpailutapahtumissa ja tällöinkin edellyttäen, että tienpitäjä antaa siihen luvan.

Liikenne- ja viestintävirasto Traficom • PL 320, 00059 TRAFICOM • p. 029 534 5000 • Y-tunnus 2924753-3

Transport- och kommunikationsverket Traficom • PB 320, 00059 TRAFICOM • tfn 029 534 5000 • FO-nummer 2924753-3

www.traficom.fi



SM ITÄRALLI 2020

Start and podium at
market place

to SS 1 - - - - - ➔

JV = Security

LO = Guides

Taksit = taxi station

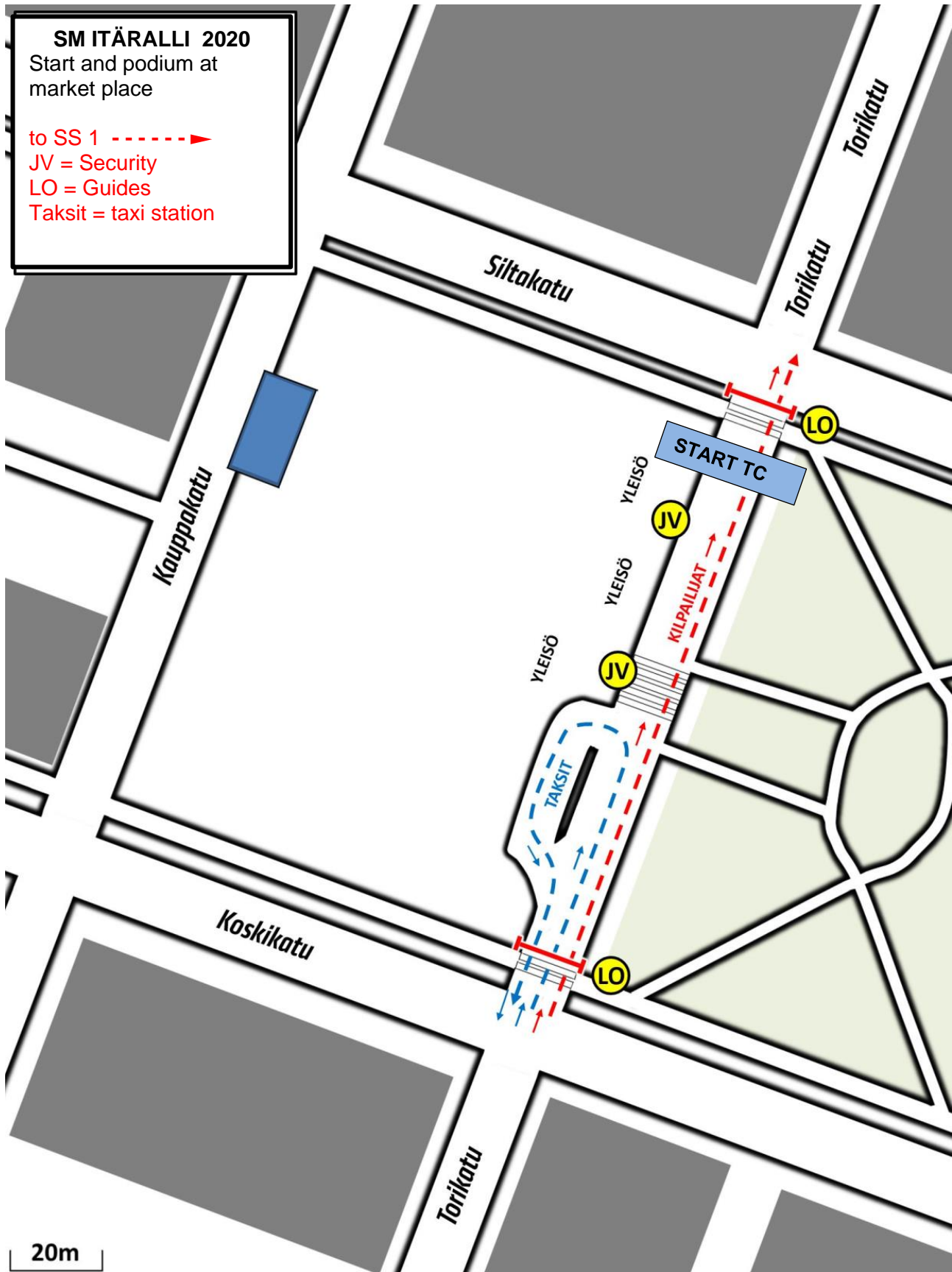

Safety equipment instructions (smartphone) Class 1-12

GPS Safety Tracking - User's Manual

In FRC events all cars will be equipped with a GPS safety tracking device, run by AKK Sports with Trax-meet. Tracking is done using the equipment and the installed application. Below you can find the main features and operation instructions, installation instructions have been given separately.

Opening Screen

When the device opens, start the RaceLive application from the icon circled with red in the picture.

You may need to swipe to the left to access this desktop page.

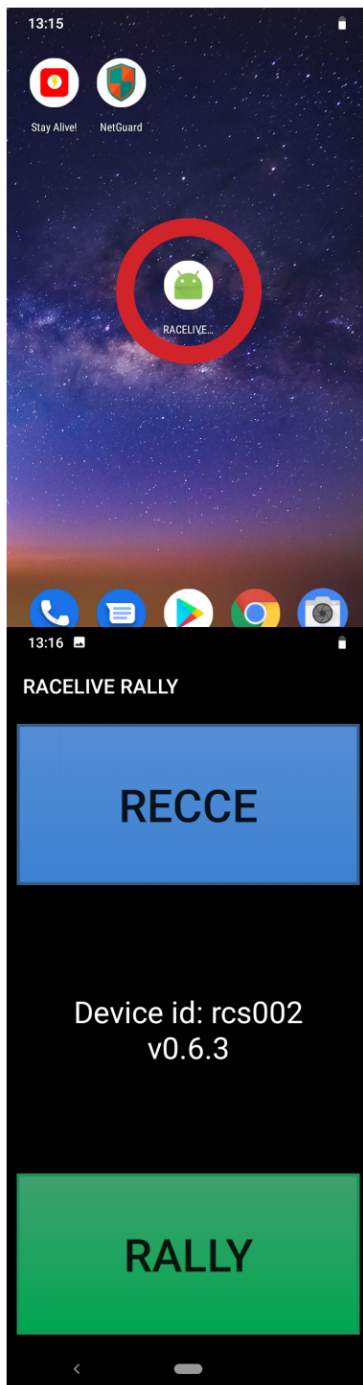

When the application opens, you choose reconnaissance tracking (RECCE) or RALLY tracking.

Reconnaissance Tracking

If you press RECCE on the start screen, the view pictured on the left will open, as the device is searching for connection.

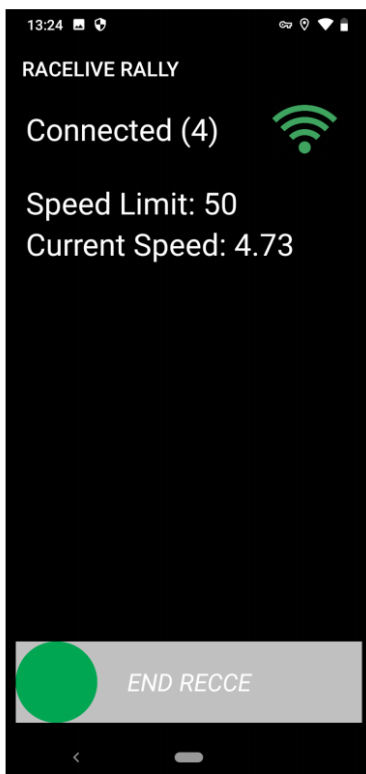
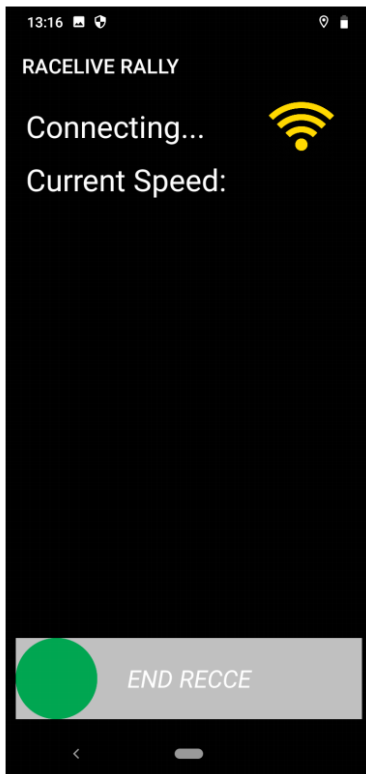

Once connected, the device will show a possible speed limit set by the organiser for a certain area (e.g. a special stage) and the your current speed.

All competitor movement within special stage areas will be registered in the application database and can be used afterwards to monitor speeds etc.

Once you finish reconnaissance, you can stop the tracking application by gliding the green dot at the bottom of the screen to the right.

Should the tracking device cause disturbance to your recce or rally intercom system (old systems are less protected), the easiest way to fix this is to wrap the intercom control box into normal aluminium foil used in kitchen.

Reconnaissance Tracking continued...

Should you go over the speed limit set by the organiser, the device will show this to the drivers (SPEEDING). The device will not show any speed limits set by the road authorities.

Any speeding will be stored in the application database.

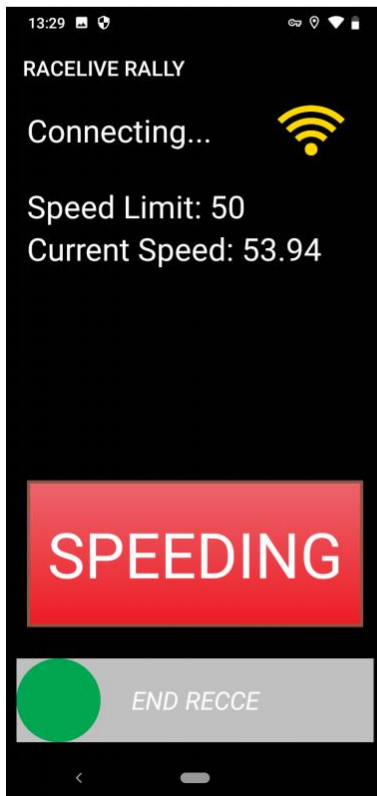

Rally Tracking

When you have chosen RALLY tracking from the start screen, the view pictured on the left will open to the screen, as the device is searching for connection.

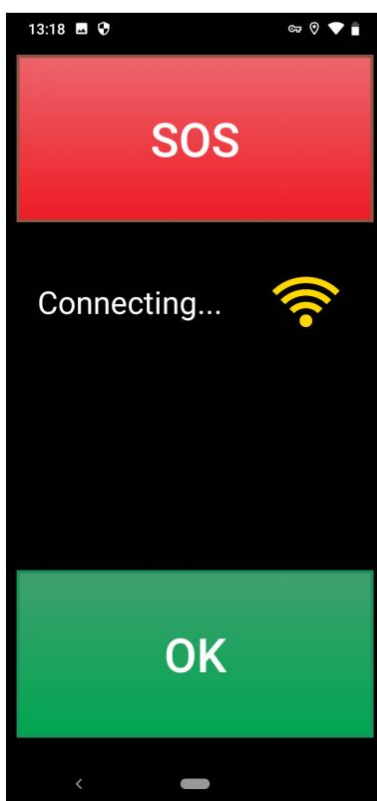

Rally Tracking continued...

Once connected, the device will show the basic status with OK and SOS buttons, and the connection confirmation.

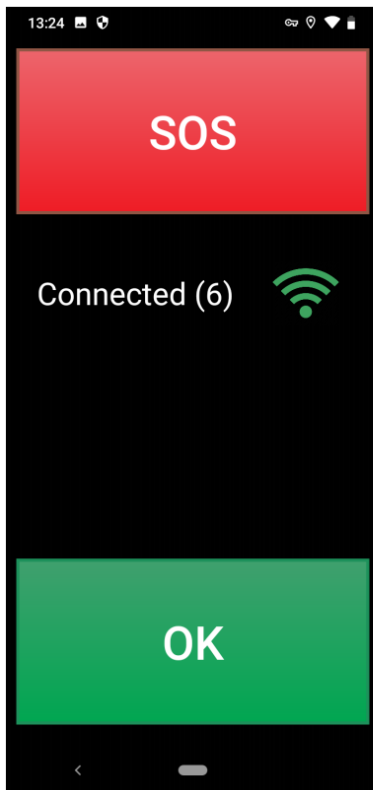

If you need to stop on stage to change a tyre or something, but there is no need for medical or fire assistance, nor any danger to the surroundings, you must press OK on the basic status screen.

When OK is pressed, the screen goes green. It will automatically return to basic status after approx. 5 seconds after pressing the OK and the message having gone through to the system.

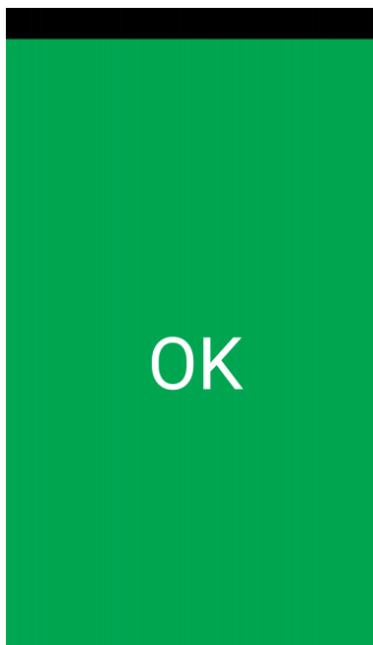

Accidents - SOS

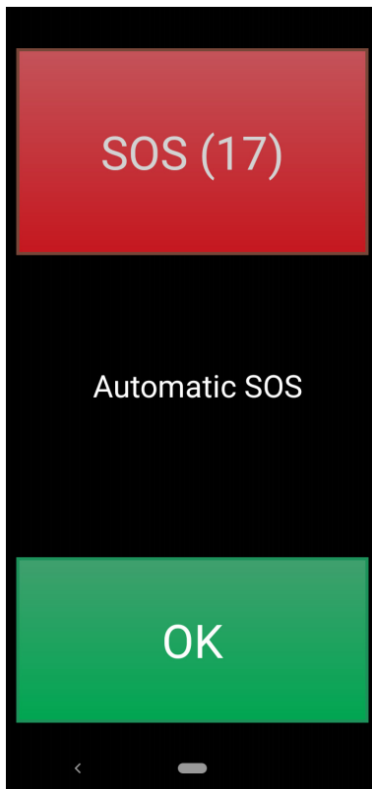

If you stop during the rally e.g. to change a tyre, the device will automatically start an SOS alarm in about 20 seconds, unless OK is pressed.

The time before the alarm is made can be seen on the SOS button (17 seconds remaining on the sample screen). It takes about 40 seconds from the moment of stopping to the time of sending the SOS.

Please remember to dismiss the automatic SOS before it is sent by pressing OK.

The Auto-SOS re-activates once the car is moving again at a minimum speed of 60 kph. Auto-SOS function is active on Special Stages only, not on road sections. When stopping at the finish of SS at the STOP control, it may activate itself, as for the device you are still "inside" the stage area according to its settings.

If an Auto SOS is sent, the device will return to basic status.

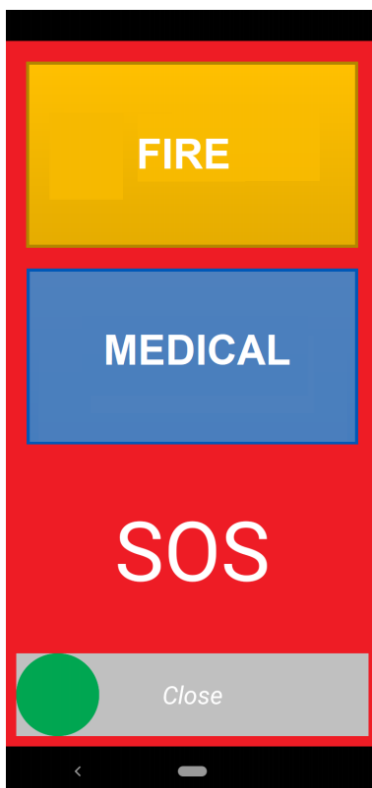

Should a competitor have an accident where help is needed, he needs to press the SOS button on the RALLY screen.

Pressing the SOS button will take the application to the mode seen on the left, with three options for the user:

1. Cancel the alarm by sliding the green dot to the right.
2. Confirm the alarm and ask for medical assistance by pressing MEDICAL.
3. Confirm the alarm and ask for extinguishing assistance by pressing FIRE.

If data connection does not work, the SOS will be sent as SMS.

After pressing FIRE/MEDICAL the button will flash for a while and the device will return to basic status, unless the SOS has been sent via SMS.

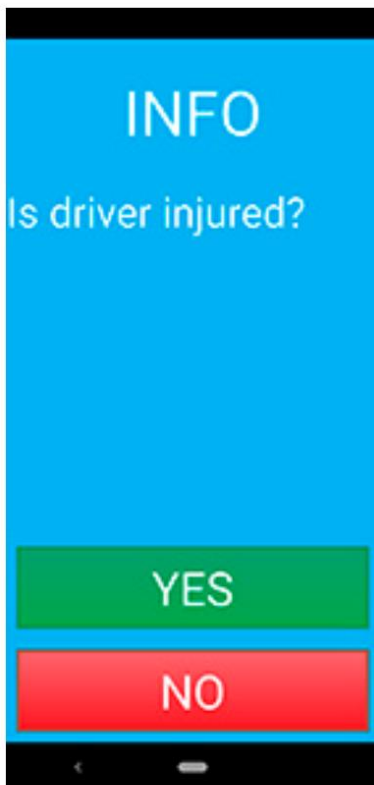

Accidents - Communication

The Rally Control has an option to communicate with the car, e.g. to get more information on the seriousness of an accident, number of patients or their condition.

The screen will then show the INFO text, the question underneath and the answer options YES and NO.

The drivers must answer accordingly. There may be multiple questions following one after the other.



Accidents - Red Flag

The application is equipped with an option for the Rally Control to send a Red Flag notification and thus stop the stage for these cars, e.g. in case of accident, road block or other reason.

This feature is not yet in use, but it may be tested on a road section according to organiser's instructions. This will be informed to the drivers.

Should you receive a Red Flag on the screen, you must confirm its reception by pressing the OK at the bottom of the screen.

The flag will remain on the screen until dismissed by Rally Control.

GPS Safety Tracking Device - Installation

AKK Sports is introducing a new GPS Safety Tracking system for the Finnish Rally Championship.

The new system requires some preparations in the rally cars. These are described below. Should you have any questions, we are happy to help.

With the new system we will have better communication facilities with the rally cars in case of any accidents, as well as a more secure communication channel between the cars and the rally control centre.

Charging Power

Each car must have a female USB power socket for 12V current. The socket must be within 50 cm of the planned installation location of the device. The connection may be part of the car's main circuit, so that when the main power is switched off it will not be discharging the battery e.g. in overnight parc fermé. You may use a basic USB socket, but it must give at least 2A of current. **Connection always to the holder (which has a 12V -> 5V converter), not the device!**

Installation in the Car

The device must be installed in the car with the equipment described in the following pictures. It is an absolute must that the device will be placed so that

- both the driver and the co-driver can reach the touch screen without opening safety belts
- both the driver and the co-driver can see the screen when driving on special stage

The RAM Mount 25 mm ball base can be borrowed or bought from the rally office. The price will be 10 Euros, either as a payment or as deposit which will be returned when the ball is returned after the rally.

Device



The tracking will be done with an application. There are no other applications in the device. Operation instructions will be given later.

The clamp mount seen in the picture does not exist, but the device will be installed with the RAM Mount ball.

Installation Equipment



This ball mount must be attached to the car with solid screws, in a place as instructed above, in order for the drivers to be able to use the device.

The device is attached to the ball with the double socket arm.

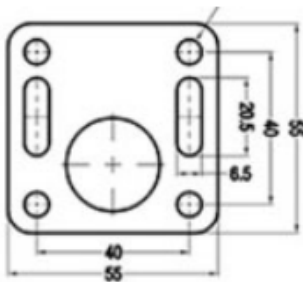

The installation measurements for the base of the ball can be seen here. Screw hole diameter is 6.5 mm and distance between the holes 40 mm.

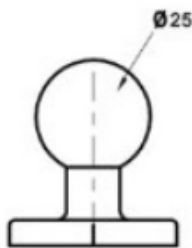

GPS Safety Tracking Device - USB Installation

The 12V USB connection as defined in the tracker installation instructions has raised a lot of questions, as the standard for USB is 5V. Our reason for asking for a 12V connection is that the connection from this female USB is made to the device holder containing a 12V->5V adapter, instead of a direct connection to the actual tracking device.

Below please find one simple and cost-effective way of doing this.

Where to start from?

The easiest option is to find the nearest Motonet (www.motonet.fi) store and get a USB socket by Hama (price 8.99€):

<https://www.motonet.fi/fi/tuote/475343/Hama-mikro-USB--adapteri-mikroB-uros-A-naaras->

The product looks like this:

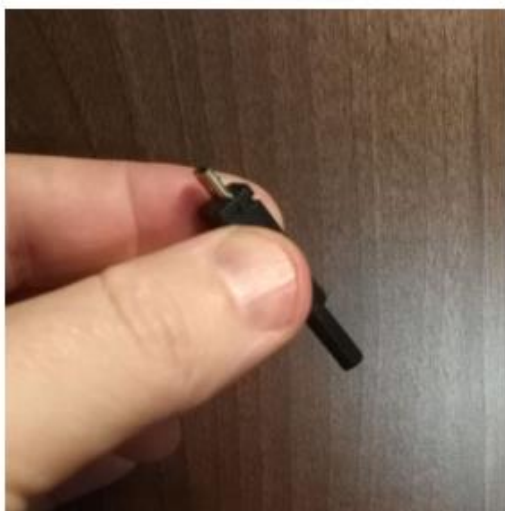

Cut the cable close to the Micro-USB.

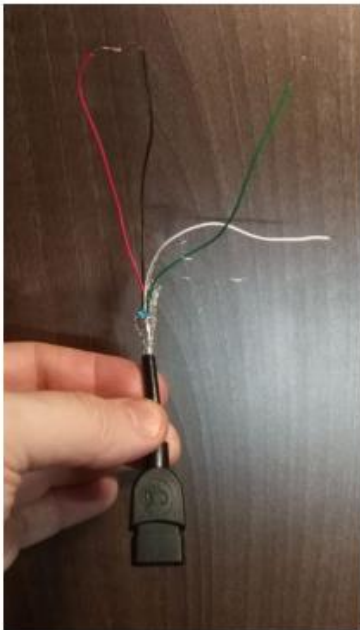

Peel the cable. There are four thin wires inside.

The white and green ones are for data transmission, forget about them.

The red and black ones are for charging. The red one is connected to the PLUS from the battery and the black to the MINUS (ground).

This female USB is then connected to the male USB coming from the tracker and you're ready!

For any further assistance in any technical matters, please contact

Chief Engineer Janne Maijala, tel. +358 40 0627500

Safety equipment instructions (old school version) Class 13-19

Tracker GTS-200

Safety Tracking Device

1. On/Off
2. Features button
3. Panic button
4. Red LED: device not ready
5. Green LED: blinks = GSM connected; light on all the time = no GSM connection
6. Yellow LED: satellite connection indicator
7. GSM-antenna on top of device
8. GPS antenna in the middle of the device
9. Charger connection
10. Charger indicator LED
11. Microphone
12. Loudspeaker
13. GSM module
14. Battery
15. Battery release

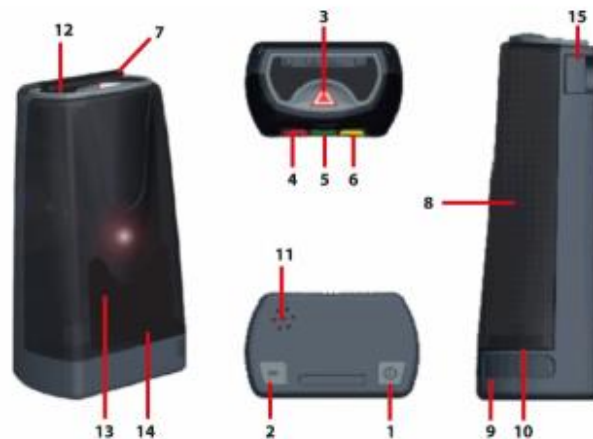

Tracker GTS-300

Safety Tracking Device

1. On/Off
2. Features button
3. Blue LED = light all time (satellite)
4. Green LED: blinks = GSM connected; light on all the time = no GSM connection
5. Red LED: battery charge
6. Mini-USB port (power cable/emergency switch)
7. SIM-kortti



Safety Tracker Installation

The trackers are delivered in a small bag, which can be used for the installation to rollcage bars with the Velcro strap of the bag, with cable ties, duct tape or similar devices.

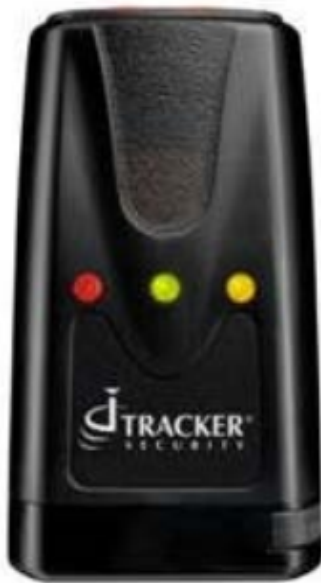

The device must be switched on by pushing the power switch (1) for at least 2 seconds with a pen or equivalent. When turned on, all LEDs will light for a while. Then they go off and the green LED will blink indicating GSM connection.

These lights do not concern the competitor as such, as long as you remember to control that the official has switched on the power on delivery.

Independent whether the unit will be installed vertically or horizontally, it is important to check that the GPS antenna is pointing up towards the sky (see picture on front page). If the antenna points to the side, it is not so dangerous, but definitely avoid pointing it towards the ground.

Please install the unit as far from the helmet intercom as possible, to avoid unnecessary disturbance (similar to GSM phone disturbance). Recommended places are any vertical or diagonal bars close to the rear or side windows.

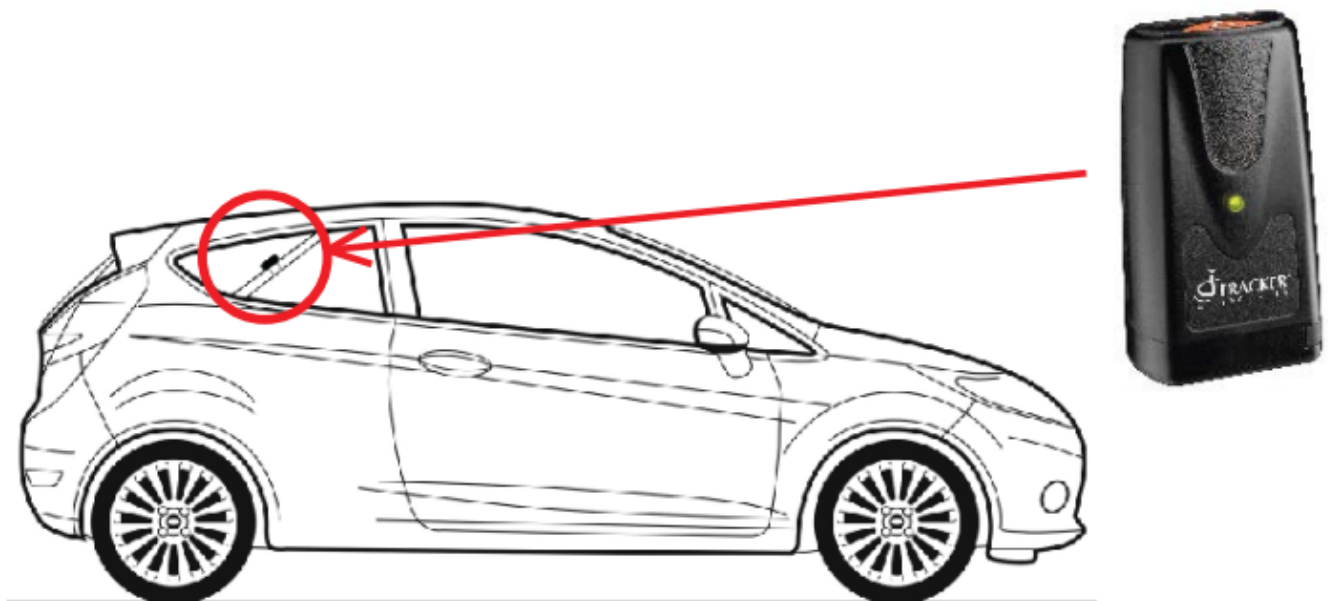

Emergency switch

The tracking device will be delivered with an emergency switch, which can be used to send an SMS to Rally Control Centre. The emergency switch should be connected to the GPS tracking device with the supplied cable to allow the alarm message to be sent. Don't break the cable! **Emergency message may only be sent if a crew member or any third person has been injured and needs immediate medical attention.**

The emergency switch must be placed in the car so that both crew members can reach to it without opening or loosening their safety belts! The switch will be delivered with some 3M DualLock tape to be used for fastening the switch to the car. After the rally, you can leave the tape to the car, ready for next event, but the switch must be returned together with the tracking device. **The cable of the emergency switch mustn't be fastened with cable ties!** The cable has one or two mounting straps.

Returning devices

The tracking device and the emergency key will be removed immediately by the organizer after the last TC of the competition.

Retirement

Retirement of the competition the competitor must disconnect the tracking device and the emergency switch from his car. The equipment must be handed over to the sweeper car or the competitor delivers the equipment to the competition center at the competition office.

Recce

During the recce, the tracking system monitors visits in special stages and controls speeds.

In two days of competitions, where the first day is recce and competition, a charging cable is provided. The charging cable is used to make sure that the battery lasts for a whole day. The competitor must transfer the tracking device to the racing car after the recce and the charge cable must be returned immediately to the competition office after the event.

In one day competitions, when one day is for recce and on the other day is competing, the charging cable isn't included. After the recce the tracking device must be returned immediately to the competition office.

These recce instructions doesn't apply in Rovaniemi.

More information:

AKK Sports Oy
Mikko Huuska

firstname.lastname@autourheilu.fi phone: +358 40 5478775